

Z315 VANDAL-PROOF ACCESS DRAIN



ENGINEERING SPECIFICATION

Zurn ZN315 10" top vandal-proof drain features Dura-Coated cast iron body bottom outlet, invertible membrane clamp, vertically adjustable nickel bronze top with secondary strainer, and hinged solid locking cover.

A Pipe Size inch [mm]	Approximate Weight lb [kg]
2 [51]	23 [10]
3 [76]	24 [11]
4 [102]	25 [11]

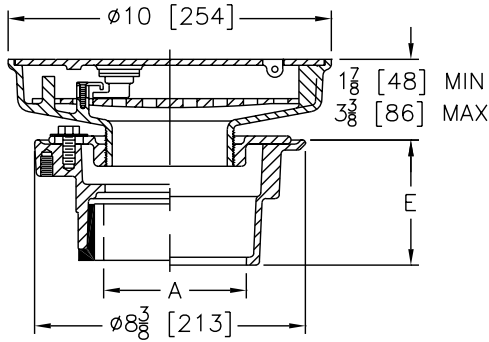

PREFIXES	DESCRIPTION	A PIPE SIZE	LIST PRICE
ZN315*	D.C.C.I Body with Polished Nickel Bronze Top	2", 3", 4"	3,461.00
OUTLETS (SPECIFY PIPE SIZE IN INCHES AND TYPE OF OUTLET)			
OUTLET TYPE	PIPE SIZE/ OUTLET TYPE	E BODY HT. DIM.	ADD
NH	No-Hub	2NH, 3NH, 4NH	3-7/8" N/C
NL	Neo-Loc	2NL, 3NL, 4NL	3-3/4" N/C
SUFFIXES			
			ADD
-G	Galvanized Cast Iron		198.00
-HL	Hinged Locking Grate		N/C
-P	Trap Primer Connection		150.00
Ⓢ -TC	Neo-Loc Test Cap Gasket (2", 3", 4" NL Bottom Outlet Only)		24.00
BEST SELLER			LIST PRICE
ZN315-3NL-P			3,611.00

Z319 THOROFLUSH DRAIN - LARGE CAPACITY



ENGINEERING SPECIFICATION

Zurn ZN319 25" large capacity thoroflush drain features cast iron body with white acid resistant coating, bottom outlet, and nickel bronze top frame and grate with flushing connection.

A Pipe Size inch [mm]	Grate Open Area sq in [cm ²]	Approximate Weight lb [kg]
3 [76], 4 [102], 6 [152], 8 [203]	232 [1496]	118 [54]

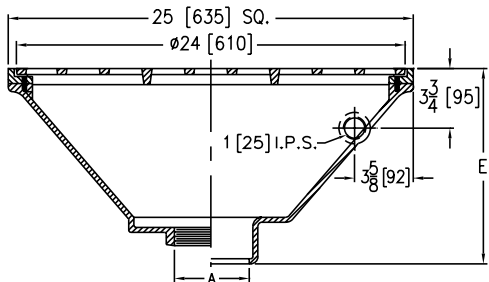

PREFIXES	DESCRIPTION	A PIPE SIZE	LIST PRICE
ZN319*	Cast Iron Body with A.R.C. Polished Nickel Bronze Top	3", 4", 6", 8"	16,570.00
OUTLETS (SPECIFY PIPE SIZE IN INCHES AND TYPE OF OUTLET)			
OUTLET TYPE	PIPE SIZE/OUTLET TYPE	E BODY HT. DIM.	ADD
IC	Inside Caulk	3IC, 4IC	12-1/8" N/C
IG	Inside Gasket	3IG, 4IG	12-1/8" N/C
IP	Threaded	3IP, 4IP, 6IP, 8IP	11" 80.00
SUFFIXES			
			ADD
-G	Galvanized Cast Iron		1,602.00
-P	Trap Primer Connection		150.00
-VP	Vandal-Proof Secured Top		206.00
SEE LEGACY ADDENDUM ON PAGE 369 FOR MORE INFORMATION			

Supplied By:



877-903-7246

www.commercialplumbingsupply.com

For additional product information, please visit www.zurn.com

*Regularly furnished unless otherwise specified.

Items designated as Best Sellers are most specified and are generally in stock for shipment.

Ⓢ This symbol denotes a product that is engineered to reduce installation and rework time.